

Specifications of timber used. All sizes are nominal (before machining) unless otherwise stated.

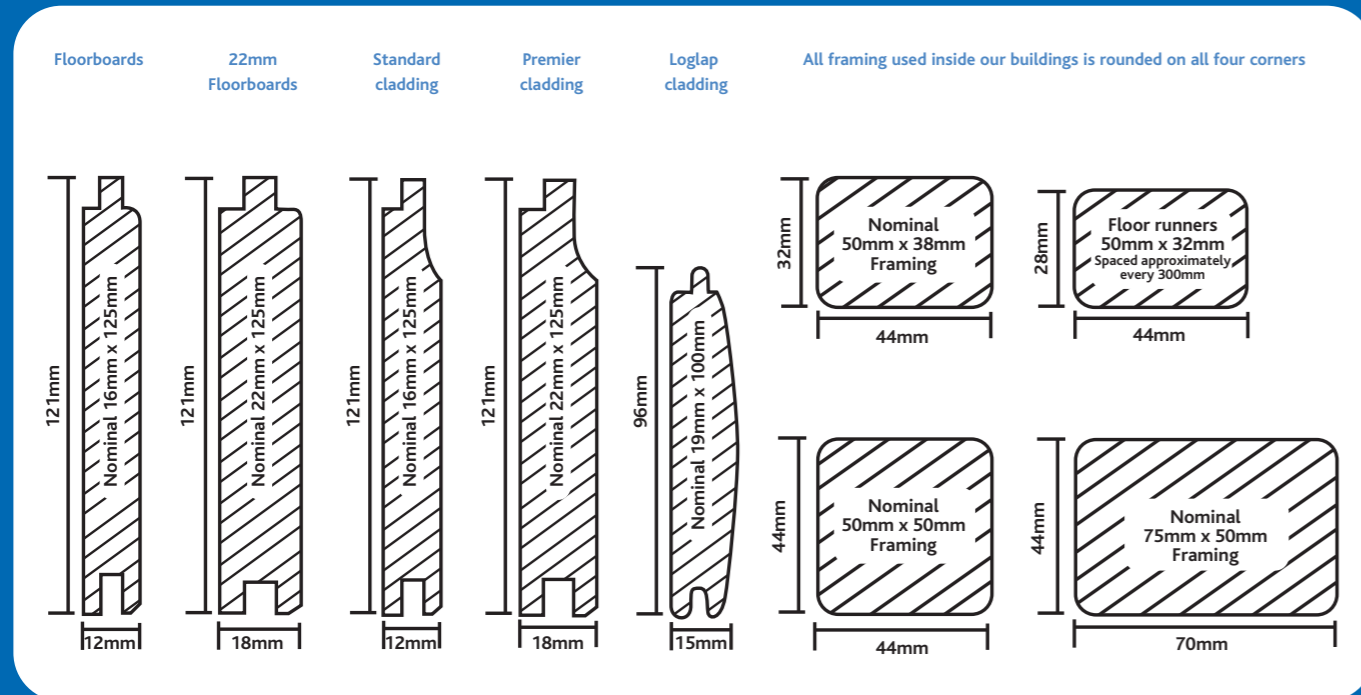

The finished sizes of our product are accurate to +/- 1mm.

PLEASE NOTE:

Buildings are available in all timber specifications and can be manufactured to your individual requirements. All measurements in the brochure are internal eaves and ridge height and for planning application purposes, the external measurements including roof and floor joists will be required.

# QUALITY BUILT TO LAST

Approved agent, stockist and distributor for Timber Garden Buildings Limited.

All contents of this brochure including photographs can only be reproduced with written permission and prior consent from Timber Garden Buildings Limited.



STORAGE AND KENNELS



SUMMERHOUSES



SHEDS



PLAYHOUSES

# contents



# contents



- |                         |                               |                                 |
|-------------------------|-------------------------------|---------------------------------|
| 4 Superior Apex         | 17 Garden Store               | 32 Corner Summer House Georgian |
| 4 Standard Apex         | 17 Garden Tidy                | 33 Corner Summer House Leaded   |
| 5 Superior Pent         | 18 Garden Chest               | 34 Blenheim Corner Summerhouse  |
| 5 Standard Pent         | 18 Wheelie Bin Store          | 35 Pavilion                     |
| 6 Hipex                 | 19 Dog Kennel                 | 36 Pent Summer House            |
| 7 Cabin                 | 19 Animal Arc                 | 37 Dual Pent Summerhouse        |
| 8 Bentley Supreme Apex  | 19 Deluxe Apex Kennel and Run | 38 Octagonal 8 and 10           |
| 8 Bentley Supreme Pent  | 20 Pent Kennel and Run        | 39 Stretched Octagonal 8        |
| 9 Potting Shed          | 20 Hen House                  | 40 Sandringham                  |
| 9 Combi-Potting Shed    | 21 Traditional Dutch Barn     | 41 Toddlers Retreat             |
| 10 Sunflower            | 22 Summer Cabin               | 42 My Little Den                |
| 11 Security Apex        | 23 Althorpe                   | 43 Ladybird Cottage             |
| 11 Security Pent        | 24 Ascot                      | 44 Snowdrop Cottage             |
| 12 Heavy Duty Apex      | 25 Balmoral                   | 45 Escape                       |
| 12 Heavy Duty Pent      | 26 Chatsworth                 | 46 Wilton Lodge                 |
| 13 Garage Apex and Pent | 27 Buckingham                 | 47 Candy Cabin                  |
| 14 Rhino Apex           | 28 Windsor                    | 48 The Hideaway                 |
| 14 Rhino Pent           | 29 Kensington                 | 49 Charleys Castle              |
| 15 Groundsman           | 30 Wentworth                  | 50 Kids Club House              |
| 16 Corner Cabin         | 31 The Elton Home Office      |                                 |

**PLEASE NOTE:** All our playhouses conform to trading standards BS5665 and are fitted with the CE mark  
 Safety features include: acrylic safety glass with planed and rounded corners on all the framing, staircases with horizontal tread, and hand rails. Doors are fitted with anti trap plastic strip to prevent finger injury.

At Timber Garden Buildings Ltd we manufacture a comprehensive range of quality garden buildings. We take great care and pride in our attention to detail and feel confident you will find a product suitable for your needs. Many options are available for all our buildings, these include; 22mm floorboards, 22mm premier cladding, 19mm log effect cladding, security products, 38mm x 50mm framing as standard, 50mm x 50mm and 50mm x 75mm framing, additional doors and windows, and increased eaves heights. If you cannot find a building to suit your needs please enquire about a custom built model as we cater for our customer needs.

We are a progressive forward thinking company and in-line with our policy of continual development and improvement reserve the right to change specifications, designs and prices without notice.

All buildings are pre-treated with quality water based wood preservative prior to delivery. To ensure longevity we recommend a top coat upon installation, and annually thereafter. Timber is a natural product, subject to changes caused by environmental conditions, to minimise contraction and expansion it is essential to maintain your building.

All timber sizes are nominal, before machining unless stated.

All building dimensions shown are approximate, based on external wall sizes, allowances should be made for roof overhangs when locating your building in a confined space.

All glass used is 3mm horticultural unless otherwise stated.



## QUALITY BUILT TO LAST



### SUPERIOR APEX STANDARD FEATURES

- Fully tongue and grooved construction
- Door can be positioned on any side or end wall
- Ledged and braced door
- Lock and key
- Interchangeable panels

### SPECIFICATION

- Sizes from:
  - 1.22m x 1.22m (4' x 4') up to 3.66m x 2.44m (12' x 8')
  - Superior Eaves Height 1864mm
  - Superior ridge Height
    - 4' - 86" / 2190mm
    - 5' - 89" / 2260mm
    - 6' - 92" / 2336mm
    - 8' - 97" / 2475mm
  - Door 1880mm x 762mm
  - Windows 610mm x 457mm
  - Framing 38mm x 50mm
  - Cladding 16mm x 125mm

### OPTIONS AVAILABLE

- 22mm premier cladding
- 19mm Log Lap cladding
- 22mm floor boards
- 50mm x 50mm framing
- Security options
- Opening window
- Felt options

## Superior & Standard Apex

### STANDARD APEX STANDARD FEATURES

- Fully tongue and grooved construction
- Ledged and braced door
- Lock and key
- Interchangeable panels

### SPECIFICATION

- Sizes from:
  - 1.22m x 1.22m (4' x 4') up to 3.66m x 2.44m (12' x 8')
  - Standard eaves ht. 1680mm
  - Standard ridge ht.
    - 4' - 78" / 1985mm
    - 5' - 81" / 2050mm
    - 6' - 85" / 2160mm



**Standard Apex -**  
If door option B,C or D are chosen then the height of the door is reduced by 190mm to 1575mm x 762mm.

- 8' - 90" / 2280mm
- Door 1765mm x 762mm
- Windows 610mm x 457mm
- Framing 38mm x 50mm
- Cladding 16mm x 125mm

### OPTIONS AVAILABLE

- 22mm premier cladding
- 19mm Log Lap cladding
- 22mm floor boards
- 50mm x 50mm framing
- security options
- opening window
- Stable Door
- Felt options

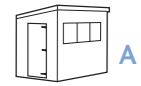

A



B

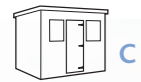

C



D

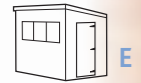

E



V



W



X



Y

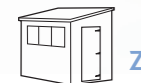

Z



#### SUPERIOR PENT STANDARD FEATURES

3" x 2" Framed roof  
Fully tongue and grooved construction  
Door can be positioned on any side or end wall  
Lock and key

#### SPECIFICATION

Sizes from:  
1.22m x 1.22m (4' x 4') to  
3.66m x 2.44m (12' x 8')  
Eaves ht. 1937mm  
Ridge ht. 2153mm  
Door 1880mm x 762mm  
Windows 610mm x 457mm  
Framing 38mm x 50mm  
Cladding 16mm x 125mm

#### OPTIONS AVAILABLE

22mm premier cladding  
19mm Log Lap cladding  
22mm floor boards  
50mm x 50mm framing  
Security options  
Felt options

## Superior & Standard Pent

#### STANDARD PENT STANDARD FEATURES

3" x 2" Roof  
Fully tongue and grooved construction  
Door can be positioned on any side or end wall  
Lock and key

#### SPECIFICATION

Sizes from:  
1.22m x 1.22m (4' x 4') to  
3.66m x 2.44m (12' x 8')  
Eaves ht. 68" / 1737mm  
Ridge ht. 76" / 1953mm  
Door (front) 1765mm x 762mm  
Door (to 4ft end) 1690mm x 762mm

Windows 610mm x 457mm  
Framing 38mm x 50mm  
Cladding 16mm x 125mm

#### OPTIONS AVAILABLE

22mm Premier cladding  
22mm Floorboards  
50mm x 50mm Framing  
Security features



## Hipex

#### STANDARD FEATURES

Fully tongued and grooved construction  
Door can be positioned on front or either end wall  
Ledged and braced door  
Lock and key

#### SPECIFICATION

Sizes from 2.44m x 1.83m (8' x 6') up to 3.66m x 2.44m (12' x 8')  
Eaves height 1.964mm  
Ridge height  
4' - 90" / 2290mm  
5' - 93" / 2360mm

6' - 96" / 2436mm  
8' - 101" / 2575mm  
Door 1765mm x 762mm  
Windows 610mm x 457mm  
Framing 38mm x 50mm  
Cladding 16mm x 125mm

#### OPTIONS AVAILABLE

50mm x 50mm framing  
22mm Premier Cladding  
19mm Log Lap Cladding  
22mm Floor boards  
Security options  
Stable door  
Felt options



## Cabin

### STANDARD FEATURES

Front and side fixed windows  
Roof overhang 1' or 300mm  
Central door

### SPECIFICATION

Sizes from:  
1.52m x 2.13m (5' x 7') up to  
2.44m x 3.05m (8' x 10')  
Eaves ht. 1680mm  
Ridge ht. 6' - 85" / 2160mm  
7' - 89" / 2270mm  
8' - 90" / 2280mm  
10' - 93" / 2370mm  
Door 1765mm x 762mm

Windows 610mm x 457mm  
Framing 38mm x 50mm  
Cladding 16mm x 125mm

### OPTIONS AVAILABLE

50mm x 50mm framing  
22mm premier cladding  
19mm Log Lap cladding  
22mm floor boards  
2'6" or 4' verandah  
Security options  
Stable door  
Felt options

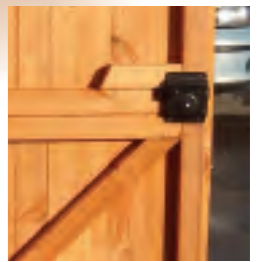

## Bentley's Supreme Apex and Pent

### PENT



### BENTLEY'S SUPREME APEX STANDARD FEATURES

Diagonal bracing in the sides  
Diagonal bracing in the ends  
38mm x 50mm boxed framed door  
6'2" High door (available in either end)  
Standard press lock and key  
Zinc plated hinges  
3 fixed windows

### SPECIFICATION – Bentley Supreme Apex

Sizes from 2.44m x 1.83m (8' x 6') up  
to 3.66m x 2.44m (12' x 8')  
Eaves height 5'10" / 1778mm  
Ridge height  
4' - 81" / 2078mm  
5' - 84" / 2143mm

6' - 88" / 2253mm  
8' - 93" / 2373mm  
Door 1778mm x 914mm  
Windows 610mm x 457mm  
Framing 38mm x 50mm  
Cladding 16mm x 125mm

### OPTIONS AVAILABLE - Bentley Supreme Apex and Pent

22mm Premier Cladding  
19mm Log Lap Cladding  
22mm Floor boards  
Increased height options which  
enables the door to be positioned on  
any side wall  
Workshop upgrade to include 4' wide  
fully framed boxed door  
Felt options

## Potting Shed



### STANDARD FEATURES

- 3" x 2" Framed roof
- Full length slatted staging under window
- Stable door
- Opening window in one end

### SPECIFICATION

- Sizes from: 1.83m x 1.83m (6' x 6') to 3.05m x 2.44m (10' x 8')
- Eaves ht. 73" / 1854mm
- Ridge ht. 81" / 2058mm
- Door 1765mm x 762mm
- Windows 6' - 1530 x 1200mm

- 8' - 2160mm x 1200mm
- 10' - 2750mm x 1200mm
- Framing 38mm x 50mm
- Cladding 16mm x 125mm

### OPTIONS AVAILABLE

- Toughened glass
- 22mm premier cladding
- 50mm x 50mm Framing
- 22mm floor boards
- Door available at either end of building
- Felt options

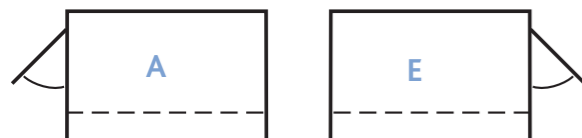

## Combi-Potting Shed



### STANDARD FEATURES

- 3" x 2" Framed roof
- Full length slatted staging under window
- Stable door
- Opening window in one end
- Integrated 4ft wide storage room with access via internal sliding door
- 2 - 4ft parallel shelves in storage room
- Profiled fascias

### SPECIFICATION

- Sizes from 1.83m x 2.44m (6' x 8') to 3.05m x 3.05m (10' x 10')
- Eaves height 2112mm / 83"

- Ridge height 2307mm / 91"
- Stable door 1765mm x 762mm
- Internal sliding door 1810mm x 762mm
- Windows 6' - 1530mm x 1200mm / 8' - 2160mm x 1200mm / 10' - 2750mm x 1200mm
- Framing 50mm x 50mm
- Cladding 16mm x 125mm

### OPTIONS AVAILABLE

- Toughened glass
- 22mm Premier cladding
- 50mm x 50mm Framing
- 22mm Floor boards
- Door available at either end
- Felt options

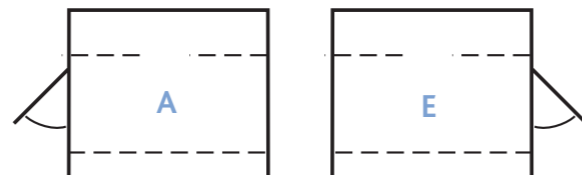

## Sunflower

### STANDARD FEATURES

- 3" x 2" Framed roof
- Full length slatted staging under window
- Full height windows returning at both ends
- Two joinery opening windows

### SPECIFICATION

- Sizes from: 1.83m x 1.83m (6' x 6') to 3.05m x 2.44m (10' x 8')
- Eaves ht. 73" / 1860mm
- Ridge ht. 81" / 2057mm
- Door 1765mm x 762mm

- Windows 6' - 1645mm x 905mm
- 8' - 2220mm x 905mm
- 10' - 2805mm x 905mm
- Framing 38mm x 50mm
- Cladding 16mm x 125mm

### OPTIONS AVAILABLE

- 22mm premier cladding
- 22mm floor boards
- 50mm x 50mm framing
- Stable door
- Door available at either end of building
- Felt options

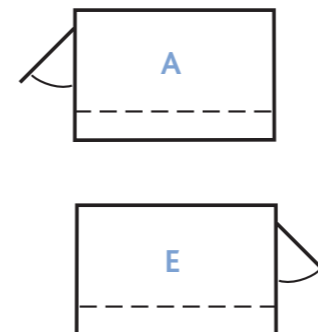

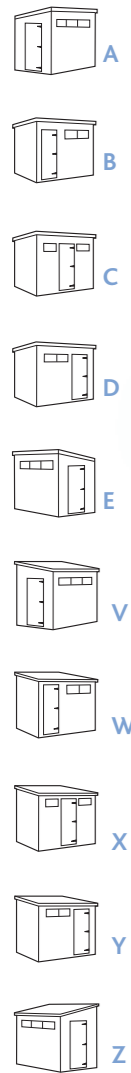

## Security Apex and Pent

PENT



### STANDARD FEATURES

Framing at 1'-300mm intervals throughout the sides for increased strength  
38mm x 50mm diagonal bracing in gable ends  
Galvanised bolted hinges  
Security bolted padbolt protector  
Internal glazed security window

### APEX SPECIFICATION

Sizes from:  
1.22m x 1.22m (4' x 4') to  
3.66m x 2.44m (12' x 8')  
Eaves ht. apex 1864mm  
Ridge ht. apex 6' - 92" / 2350mm  
8' - 97" / 2475mm  
Door 1880mm x 762mm  
Windows 1220mm x 150mm

Framing 38mm x 50mm  
Door fully framed and braced in 50mm x 50mm framing  
Cladding 16mm x 125mm

### PENT SPECIFICATION

Eaves ht 76" / 1937mm  
Ridge ht 84" / 2153mm  
Door 1880mm x 762mm

### OPTIONS AVAILABLE

50mm x 50mm framing  
22mm premier cladding  
22mm floor boards  
3' Door  
4' Double Doors  
5' Double Doors  
Door ramp  
Felt options



## Heavy Duty Apex and Pent

PENT



### STANDARD FEATURES

50mm x 50mm framing throughout with diagonal bracing  
Substantial 75mm x 50mm roof truss:  
1 up to 15ft  
3 up to 20ft  
5 up to 30ft  
Heavy duty roofing felt  
Joinery windows

### APEX SPECIFICATION

Sizes from:  
3.05m x 2.44m (10' x 8') to  
9.14m x 3.66m (30' x 12')  
Eaves ht. 1895mm  
Ridge ht. 8' - 98" / 2490mm  
10' - 102" / 2595mm  
12' - 106" / 2690mm

Door 1880mm x 762mm  
Windows 610mm x 457mm  
Opening window 552mm x 400mm  
Framing 50mm x 50mm  
Cladding 16mm x 125mm

### PENT SPECIFICATION

Eaves ht. 76" / 1937mm  
Ridge ht. 84" / 2153mm  
Door 1880mm x 762mm

### OPTIONS AVAILABLE

22mm premier cladding  
22mm floor boards  
4', 5', 6' or 7' double doors  
Security options  
Felt options



## Garage

### STANDARD FEATURES

50mm x 50mm framing throughout with diagonal side bracing  
Substantial 75mm x 50mm roof truss:  
1 up to 15ft  
3 up to 20ft  
5 up to 30ft  
Heavy duty roofing felt  
Joinery windows

### SPECIFICATION

Sizes from:  
3.05m x 2.44m (10' x 8') to  
9.14m x 3.66m (30' x 12')  
Eaves ht. 74" / 1895mm  
Ridge ht. 8' - 94" / 2490mm  
10' - 102" / 2595mm

12' - 106" / 2690mm  
Double Doors 1880mm x 2135mm  
Side Door 1775mm x 762mm  
All doors are in 75mm x 50mm framing and braced  
Windows 610mm x 457mm  
Opening window 552mm x 400mm  
Framing 50mm x 50mm  
Cladding 16mm x 125mm

### OPTIONS AVAILABLE

22mm premier cladding  
4', 5', 6' or 7' fully framed 75mm x 50mm double doors  
With lock and key  
Security options  
Felt options



Pent Garage available on request



## Rhino

### STANDARD FEATURES

75mm x 50mm Fully framed door  
Roof constructed of 75mm x 50mm framing  
Door can be positioned at any side or end wall  
Mortice lock and key with antique handles  
30" fully framed boxed door and fully boarded both sides  
Heavy duty hinges  
75mm x 50mm framed roofing truss  
3 fixed windows  
Heavy duty felt

### APEX SPECIFICATION

Sizes from 2.44m x 1.83m (8' x 6') up to 3.66m x 2.44m (12' x 8')  
Eaves height 1.864mm

Ridge height  
4' - 86" / 2190mm  
5' - 89" / 2260mm  
6' - 92" / 2336mm  
8' - 97" / 2475mm  
Door 1880mm x 762mm  
Windows 610mm x 457mm  
Framing 75mm x 50mm  
Cladding 16mm x 125mm

### PENT SPECIFICATION

Eaves height 76" / 1937mm  
Ridge height 85" / 2153mm

### OPTIONS AVAILABLE - Apex & Pent

22mm Premier Cladding  
19mm Log Lap Cladding  
22mm Floor boards  
Felt options  
Larger sizes available upon request

### PENT







## The Groundsman



### STANDARD FEATURES

4ft double doors boarded both sides,  
75mm x 50mm fully framed  
Roof constructed of 75mm x 50mm  
framing  
Doors can be positioned on any side  
or end wall  
Diagonal bracing to sides and ends  
Mortice lock and key with antique  
handles  
Heavy duty hinges  
75mm x 50mm Framed roof truss  
Joinery windows  
Untreated workbench (h) 825mm x  
(w) 1850mm x (d) 635mm  
Heavy duty felt

### APEX SPECIFICATION

Sizes from 2.44m x 1.83m (8' x 6') up  
to 3.66m x 2.44m (12' x 8')

Eaves height. 1.864m  
Ridge height:  
4' - 86" / 2190mm  
5' - 89" / 2260mm  
6' - 92" / 2336mm  
8' - 97" / 2475mm  
Door 1880mm x 1220mm  
2 fixed windows 610mm x 457mm  
1 opening window 552mm x 400mm  
Framing 75mm x 50mm  
Cladding 16mm x 125mm

### PENT SPECIFICATION

Eaves height 76" / 1937mm  
Ridge height 85" / 2153mm

### OPTIONS AVAILABLE - Apex & Pent

22mm Premier Cladding  
19mm Log Lap Cladding  
22mm Floor boards  
Felt options  
Larger sizes available upon request

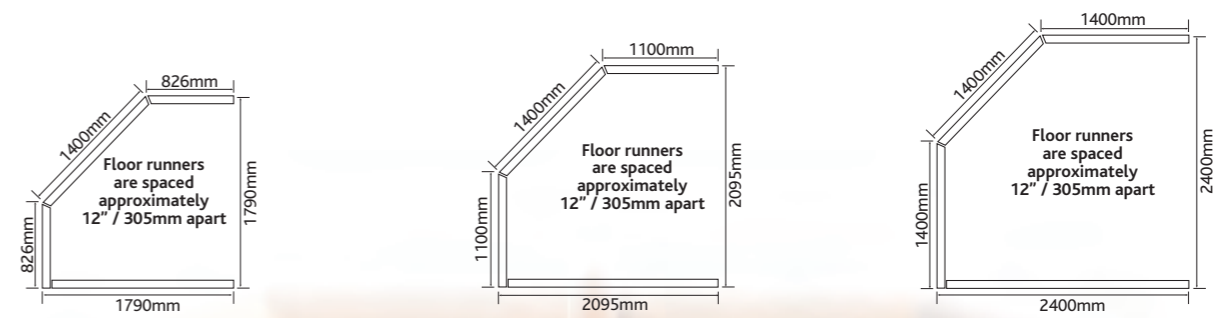

## Corner Cabin

### STANDARD FEATURES

3' wide door ledged and braced  
50mm x 50mm door with rim lock,  
door knob and 16" zinc coated door  
hinges  
Joinery opening windows

### SPECIFICATION

Eaves ht. 76" / 1937mm  
Ridge ht. 84" / 2153mm  
Door 1880mm x 914mm  
Windows 610mm x 457mm  
Framing 38mm x 50mm

### OPTIONS AVAILABLE

22mm Premier cladding  
22mm floor boards  
50mm x 50mm framing  
4ft double doors on all sizes  
Felt options

## Garden Store



### SPECIFICATION

Size: 1.52m x 915mm (5'x3')  
Eaves ht. 1610mm  
Ridge ht. 1710mm  
Door 1460mm x 762mm Braced with lock and key  
Framing 38mm x 50mm  
Cladding 16mm x 125mm  
Roof can slope either way

### OPTIONS AVAILABLE

Doors available in any position  
22mm Premier cladding  
22mm floor boards

## Garden Tidy



### SPECIFICATION

Size: 1.83m x 762mm (6' x 2'6")  
Eaves ht. 1610mm  
Ridge ht. 1710mm  
Double doors 1460mm x 1320mm  
Braced with lock and key  
Framing 38mm x 50mm  
Cladding 16mm x 125mm  
Roof can slope either way

### OPTIONS AVAILABLE

Doors available in any position  
22mm Premier cladding  
22mm floor boards

## Garden Chest



### STANDARD FEATURES

Hinged lid with hasp and staple  
Sliding internal storage shelf

### SPECIFICATION

Size: 1.52m x 610mm (5' x 2')  
Eaves ht. 710mm  
Ridge ht. 802mm  
Framing 38mm x 50mm  
Cladding 16mm x 125mm

## Wheelie Bin Store



### SPECIFICATION

Size: 2134mm x 915mm (7' x 3')  
Eaves ht. 1555mm  
Ridge ht. 1655mm  
Slated Double Doors 1550mm x 937mm (x2)  
Framing 38mm x 50mm  
Cladding 16mm x 125mm (to sides and back)  
Roof can slope either way  
Tower bolt fitted to each door

No floor inside this building

### OPTIONS AVAILABLE

22mm Premier cladding  
19mm Log lap

## Dog Kennel



### SPECIFICATION

sizes: 1.22m x 915mm  
(4' x 3')  
1.22m x 1.22m (4' x 4')  
eaves ht. 660mm  
ridge ht. 940mm

hole size 380mm x 305mm  
framing 38mm x 50mm  
cladding 16mm x 125mm

## Animal Arc



### SPECIFICATION

2 Sliding hatches, one at  
either end  
4' x 3' 5" (at base) Run  
with 13mm x 13mm  
galvanised wire mesh  
2'4 x 3' 5" (at base) Hut

with access hole  
Size 1930mm x 1041mm  
(6'4" x 3'5")  
Ridge 1016mm / 40"  
Doors 254mm x 279mm  
Internal access hole height  
190mm

## Deluxe Apex Kennel



### STANDARD FEATURES

4' x 6' kennel unit with floor  
and access door with closing  
bob hole  
6' x 6' run with 50mm x 50mm  
Galvanised weldmesh on  
50mm x 50mm framing, with front  
Access door  
Run designed with bottom drainage  
for easy cleaning

### SPECIFICATION

Size: 3.05m x 1.83m (10' x 6')  
Eaves ht. kennel 1780mm  
Eaves ht. run 1832mm  
Ridge ht. kennel 2250mm  
Ridge ht. run 2305mm  
Door in run 1757mm x 600mm  
Door in kennel 1765mm x 604mm  
Framing 50mm x 50mm  
Cladding 16mm x 125mm

### OPTIONS AVAILABLE

22mm premier cladding  
19mm Log Lap cladding  
22mm floorboards

## Pent Kennel 6' and 8' run



### STANDARD FEATURES

4' x 4' kennel with floor, front door  
and side with tower bolt  
Dog access hole  
Run made from 50mm x 50mm  
galvanised heavy duty wire mesh, on  
50mm x 50mm framing,  
Door with tower bolt

### SPECIFICATION

Sizes: 3.05m x 1.22m (10' x 4') and  
3.66m x 1.22m (12' x 4')  
Eaves ht. 1433mm  
Ridge ht. 1610mm  
Doors 1455mm x 596mm  
Framing kennel 38mm x 50mm  
Framing run 38mm x 50mm and  
50mm x 50mm  
Cladding 16mm x 125mm

### OPTIONS AVAILABLE

22mm premier cladding  
19mm Log Lap cladding  
22mm floorboards  
Run on left side opposite to main  
picture  
6' or 8' run

## Hen House



### STANDARD FEATURES

3' X 6' Hen house with raised floor  
and single door. Separate closing hen  
access door and ramp  
3' x 6' run with 13mm x 13mm  
Galvanised weldmesh, and meshed  
door

### SPECIFICATION

Size: 1.83m x 1.83m (6' x 6')  
Eaves ht. 69 1/4" / 1760mm  
Ridge ht. 87 3/4" / 2230mm  
Meshed door 610mm x 1760mm  
Single door in Hen house 1460mm x  
915mm  
Hen house access door 485mm x  
380mm  
Ramp 315 x 750  
Framing 50mm x 50mm  
Cladding 16mm x 125mm

### OPTIONS AVAILABLE

Attachable Nesting Box:  
Size: 480mm x 1830mm (19" x 6")  
Comprising of 3 nesting  
compartments each 585 mm x  
355mm  
Eaves ht. 31 1/2" / 800mm  
Ridge ht. 36 1/2" / 927mm  
22mm Premier cladding  
19mm Log lap  
22mm floorboards



## Traditional Dutch Barn

### STANDARD FEATURES

Fully framed & braced 5ft barn style double doors  
Door knob handle  
Rim lock & key  
One fixed window above door  
Galvanised hinges  
16mm x 125mm shiplap cladding  
50mm x 50mm framing  
1 internal shelf 33" wide  
Green mineral felt (not shown in picture)  
18' x 18" toughened glass

### SPECIFICATION

Sizes available from 8ft x 6ft to 30ft x 10ft  
Eaves height on all sizes 1680mm / 66"  
Ridge height 6ft - 2605mm / 102"  
Ridge height 8ft - 2980mm / 117"  
Ridge height 10ft - 3355mm / 132"

Door size 5ft double doors barn style with 22mm tongue & grooved cladding

Fixed Georgian window size 18" x 18" / 460mm x 460mm  
Framing 50mm x 50mm  
Cladding 16mm x 125mm

### OPTIONS AVAILABLE

Framing 75mm x 50mm  
22mm Premier cladding (as shown in picture)  
19mm Log lap  
22mm heavy duty floor boards  
Felt options including tiles (as shown in picture)  
Joinery opening side windows  
Additional fixed window in the rear apex  
Security option on door  
Additional shelving



Internal roof and shelf



## Summer Cabin

### STANDARD FEATURES

Roof overhang 1' / 305mm  
Four diamond leaded windows  
Stable door with ornate antique hinges  
Rim lock and knob handle  
Profiled fascia boards

### SPECIFICATION

Sizes from: 1.52m x 2.13m (5' x 7') to 2.44m x 3.05m (8' x 10')  
Eaves ht. 66" / 1680mm  
Ridge ht. 6' - 85" / 2160mm  
7' - 89" / 2270mm  
8' - 90" / 2280mm  
10' - 93" / 2370mm

Door 1765mm x 762mm  
Windows 610mm x 457mm  
Framing 38mm x 50mm  
Cladding 16mm x 125mm

### OPTIONS AVAILABLE

22mm premier cladding  
19mm Log Lap Cladding  
22mm floor boards  
Veranda 2'6" or 4'  
50mm x 50mm framing  
Square leaded windows  
Toughened glass  
Felt options



## The Althorpe

### STANDARD FEATURES

Half Glazed arched top doors with antique hinges, ornate handle and lever lock  
2 Arched top front fixed windows  
Door Drip  
Roof overhang 1' / 305mm

### SPECIFICATION

Sizes: 1.52m x 2.13m (5x7) and 2.13m x 2.13m (7x7) only  
Eaves height 73" / 1864mm  
Ridge height 91" / 2312mm  
Door 1790mm x 1103mm  
Windows 445mm x 1010mm  
Framing 38mm x 50mm  
Cladding 16mm x 125mm

### OPTIONS AVAILABLE

22mm Premier Cladding  
19mm Log Lap cladding  
22mm Heavy Duty Floor Boards  
2'6" or 4' Veranda  
Side window fixed or opening  
Square or diamond leaded windows  
Felt options



## The Ascot

### STANDARD FEATURES

Fully glazed plain glass double doors with antique hinges, ornate handle and lever lock  
2 front fixed plain full length windows  
2 side fixed plain full length windows  
Roof overhang 1' / 305mm  
Door drip  
Profiled fascia boards

### SPECIFICATION

Sizes from 1.83m x 2.44m (6'x8') to 3.66m x 3.66 (12' x 12')  
Eaves height 72" / 1838mm  
Ridge height 8' - 97" / 2466mm,  
10' - 102" / 2580mm,

12' - 106" / 2700mm  
Doors 1790mm x 1103mm  
Windows 1622mm x 452mm  
Framing 38mm x 50mm  
Cladding 16mm x 125mm

### OPTIONS AVAILABLE

Opening windows  
22mm Premier cladding  
19mm Log lap  
22mm Floor boards  
Toughened glass  
50mm x 50mm Framing  
2'6" or 4' Veranda  
Felt options.



## The Balmoral

### STANDARD FEATURES

Half glazed joinery doors, with antique hinges, ornate handle and lever lock  
4 front fixed windows  
Roof overhang 1' / 305mm  
Profiled fascia boards  
Door drip

### SPECIFICATION

Sizes from: 1.83m x 2.44m (6' x 8') to 3.66m x 3.66m (12' x 12')  
Eaves ht. 73" / 1864mm  
Ridge ht. 8' / 98" / 2490mm  
10' - 101" / 2570mm  
12' - 104" / 2655mm  
Double doors 1790mm x 1103mm  
Windows: 7' - 400mm x 400mm

Ridge ht. 8' - 553mm x 400mm  
10' - 610 x 457mm  
12' - 610 x 457mm  
Framing 8' - 38mm x 50mm  
10' - 38mm x 50mm  
12' - 50mm x 50mm  
Cladding 16mm x 125mm

### OPTIONS AVAILABLE

22mm premier cladding  
19mm Log Lap Cladding  
22mm floor boards  
Toughened glass  
50mm x 50mm framing  
2'6" or 4' veranda  
Felt options



## The Chatsworth

### STANDARD FEATURES

Fully glazed Georgian double doors with antique hinges, ornate handle and lever lock  
2 front fixed Georgian windows, if building is a 10ft front the 2 fixed windows become opening windows as standard  
2 top hung opening Georgian side windows  
Roof overhang 1' / 305mm  
Door drip  
Profiled fascia boards

### SPECIFICATION

Sizes from: 1.83m x 2.44m (6' x 8') to 3.66m x 3.66m (12' x 12')  
Eaves ht. 73" / 1864mm

Ridge ht. 8' - 97" / 2466mm  
10' - 102" / 2580mm  
12' - 106" / 2700mm  
Doors 1790mm x 1103mm  
Windows 1010mm x 475mm  
1040mm x 717mm  
Framing 38mm x 50mm  
Cladding 16mm x 125mm

### OPTIONS AVAILABLE

22mm premier cladding  
19mm Log Lap Cladding  
22mm floor boards  
Toughened glass  
50mm x 50mm framing  
2'6" or 4' veranda  
Felt options



## The Buckingham

### STANDARD FEATURES

Fully glazed georgian door with antique hinges, ornate handle and lever lock  
Georgian bay window  
1 Georgian top hung opening side window  
Roof overhang 1' / 305mm  
Profiled fascias  
Door drip

### SPECIFICATION

Sizes from: 1.83m x 1.83m (6' x 8') to 3.66m x 3.66m (12' x 12')  
Eaves ht. 73" / 1864mm  
Ridge ht. 8' - 98" / 2490mm  
10' - 101" / 2570mm  
12' - 104" / 2655mm

Door 1790mm x 762mm  
Windows 1040mm x 717mm  
Bay window 1035mm x 1035mm  
Framing 8' - 38 x 50mm  
10' - 38mm x 50mm  
12' front - 50mm x 50mm  
Cladding 16mm x 125mm

### OPTIONS AVAILABLE

22mm premier cladding  
22mm floor boards  
Toughened glass  
50mm x 50mm framing  
19mm Loglap Cladding  
2'6" or 4' veranda  
Mirror image available  
Felt options



## The Windsor

### STANDARD FEATURES

Fully glazed georgian double doors, antique hinges, ornate handle and lever lock  
Georgian bay window  
2 Georgian top hung opening side windows  
Roof overhang 1' / 305mm  
Side wings 305mm  
Profiled fascias  
Door drip

### SPECIFICATION

Sizes from: 1.83m x 3.05m (6' x 10') to 3.66m x 3.66m (12' x 12')  
Eaves ht. 73" / 1864mm  
Ridge ht. 10' - 101" / 2570mm  
12' - 104" / 2655mm

Double doors 1790mm x 1103mm  
Windows 1040mm x 717mm  
Bay window 1035mm x 1035mm  
Framing 10' - 38mm x 50mm  
12' front - 50 x 50mm  
Cladding 16mm x 125mm

### OPTIONS AVAILABLE

22mm premier cladding  
19mm Log Lap Cladding  
22mm floor boards  
Toughened glass  
50mm x 50mm framing  
Mirror image available  
Felt options



## The Kensington

### STANDARD FEATURES

Fully glazed georgian double doors with antique hinges, ornate handle and lever lock

2 Georgian front windows

8ft front has 6 pane fixed

10ft / 12ft front has 9 pane openers

2 Georgian opening side windows

Roof overhang 1' / 305mm

Side wings 305mm

Profiled fascias

Door drip

### SPECIFICATION

Sizes from: 1.83m x 3.05m (6' x 10') to 3.66m x 3.66m (12' x 12')

Eaves ht. 73" / 1864mm

Ridge ht. 8' - 98" / 2490mm

10' - 101" / 2570mm

12' - 104" / 2655mm

Double doors 1790mm x 1103mm

Windows 1040mm x 717mm

Framing 8' - 38mm x 50mm

10' - 38mm x 50mm

12' front - 50mm x 50mm

Cladding 16mm x 125mm

### OPTIONS AVAILABLE

22mm premier cladding

22mm floor boards

Toughened glass

50mm x 50mm framing

19mm Log Lap cladding (picture shown in loglap cladding), this is not a standard feature

Felt options



## Wentworth

### STANDARD FEATURES

Fully glazed georgian doors with antique hinges, ornate handle and lever lock

2 Georgian fixed front windows

2 top opening georgian side windows

4' veranda with plant boxes and side wings

Profiled fascia and veranda boards

Door drip

### SPECIFICATION

Sizes from: 3.05m x 3.05m (10' x 10') to 4.87m x 3.66m (16' x 12')

Eaves ht. 74" / 1891mm

Ridge ht. 10' - 101" / 2560mm

12' - 104" / 2645mm

Double doors 1790mm x 1510mm

Windows 1010mm x 475mm

1040mm x 717mm

Framing 50mm x 50mm

Cladding 16mm x 125mm

### OPTIONS AVAILABLE

22mm premier cladding

19mm Log Lap Cladding

22mm floor boards

Toughened glass

Felt options





## The Elton Home Office

### STANDARD FEATURES

Georgian half glazed door with arched inserts to accommodate double glazed units (not included)  
Heavy duty bolted black door hinges  
Door drip  
Georgian opening windows with arched inserts to accommodate double glazed units (not included)  
Roof overhang 1' / 305mm  
75mm x 50mm framing to sides and ends and braced  
Profiled fascias

### SPECIFICATION

Sizes from: 2.44m x 3.05m (8' x 10') to  
4.87m x 3.66m (16' x 12')  
Eaves ht. 82" / 2088mm

Ridge ht. 10' - 110" / 2790mm  
12' - 113" / 2865mm  
Door 1990mm x 762mm  
Front window 1000mm x 1043mm  
Side window 1413mm x 1043mm  
Framing 75mm x 50mm  
Cladding 16mm x 125mm

### OPTIONS AVAILABLE

22mm premier cladding  
19mm Log Lap cladding  
22mm floorboards  
Additional side window  
Double glazing  
Toughened glass  
Mirror image available  
Felt options

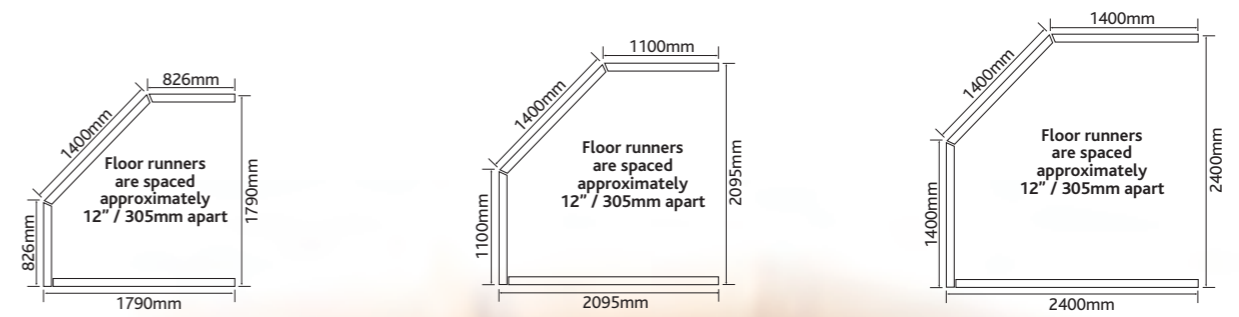

## Corner Summerhouse Georgian

### STANDARD FEATURES

Fully glazed Georgian double doors with antique hinges, ornate handle and lever lock  
2 Georgian top opening side windows  
Door drip

### SPECIFICATION

Sizes from: 1.83m x 1.83m (6' x 6')  
2.13m x 2.13m (7' x 7')  
2.44m x 2.44m (8' x 8')  
Eaves ht. 76" / 1942mm  
Ridge ht. 84" / 2146mm  
Double doors 1790mm x 1103mm  
Windows 1040mm x 717mm

Framing 38mm x 50mm  
Cladding 16mm x 125mm

### OPTIONS AVAILABLE

22mm premier cladding  
19mm Log Lap Cladding  
22mm floor boards  
Toughened glass  
50mm x 50mm framing  
Felt options

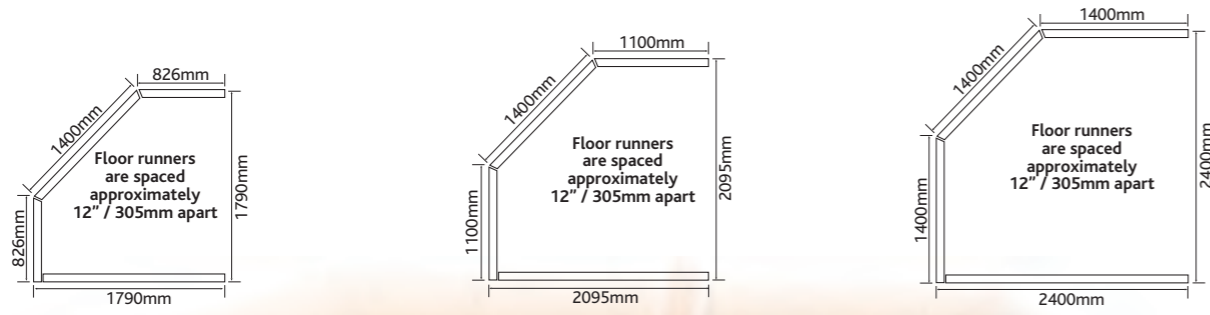

## Corner Summerhouse Leaded

### STANDARD FEATURES

- Fully glazed double doors with leaded glass and antique hinges, ornate handle and lever lock
- 2 leaded glass top opening side windows
- Door drip

### SPECIFICATION

- Sizes from: 1.83m x 1.83m (6' x 6')
- 2.13m x 2.13m (7' x 7')
- 2.44m x 2.44m (8' x 8')
- Eaves ht. 76" / 1942mm
- Ridge ht. 84" / 2146mm
- Double doors 1790mm x 1103mm

- Windows 1040mm x 717mm
- Framing 38mm x 50mm
- Cladding 16mm x 125mm

### OPTIONS AVAILABLE

- 22mm cladding
- 19mm Log Lap Cladding
- 22mm floor boards
- Toughened glass
- 50mm x 50mm framing
- Felt options

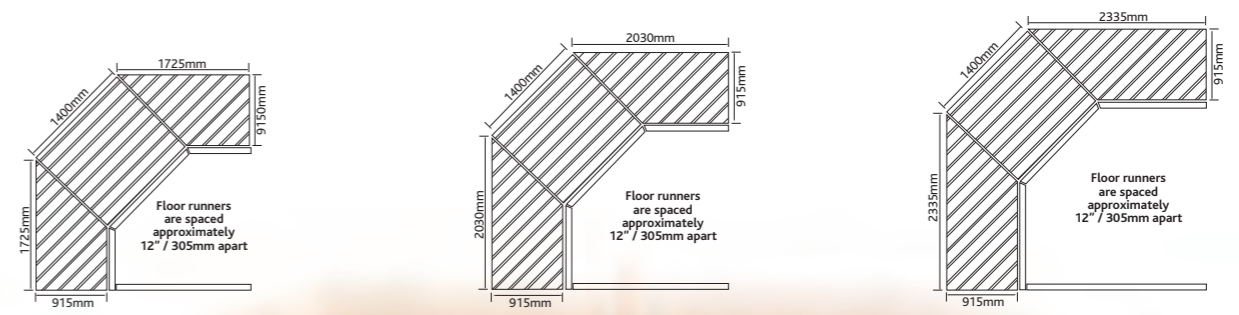

## Blenheim Corner Summerhouse



Option available without upright supports

### STANDARD FEATURES

- Fully glazed Georgian double doors
- Antique hinges
- Ornate handle with lever lock
- 2 top hung side windows
- Door drip
- Includes 3' veranda with roof overhang
- Roof is boarded on the underside of veranda

### SPECIFICATION

- Sizes available from 9ft x 9ft to 11ft x 11ft including 3ft veranda
- Eaves height 76" / 1942
- Ridge height 95" / 2410
- Doors 1790mm x 1103mm

- Windows either side of door, 6 pane on 9ft x 9ft, 9 pane on 10ft x 10ft & 11ft x 11ft
- Framing 38mm x 50mm
- Cladding 16mm x 125mm

### OPTIONS AVAILABLE

- Diamond leaded, square leaded glazing or plain glazing
- 22mm premier cladding
- 22mm heavy duty floor boards
- 19mm log lap
- 50mm x 50mm framing
- 75mm x 50mm framing
- Toughened glass
- Felt options
- Profiled fascia boards
- Without upright supports



## Pavilion

### STANDARD FEATURES

Georgian double doors, antique hinges, ornate handle and lever lock  
2 Georgian top hung 12 pane, opening side windows  
2 front fixed Georgian windows

The front roof canopy is 485mm wide and tiled in red, green, black or slate tiles. The roof is felted with green roofing felt.

Profiled fascia boards

### SPECIFICATION

Sizes from 2.44m x 1.83m (8x6) up to 3.05m x 2.44m (10x8)  
Eaves height 77" / 1950mm

Ridge height 88" / 2170mm  
Double doors 1790mm x 1103mm  
Windows 1360mm x 718mm  
Framing 38mm x 50mm  
Cladding 16mm x 125mm

### OPTIONS AVAILABLE

22mm premier cladding  
19mm Log Lap cladding  
22mm Heavy Duty floor  
Toughened Glass  
50mm x 50mm framing  
Felt options



## Pent Summerhouse

### STANDARD FEATURES

Fully glazed Georgian double doors with antique hinges, ornate handle and lever lock  
2 Georgian fixed front windows  
2 Georgian 9 pane opening side windows  
Profiled fascias  
Door drip

### SPECIFICATION

Sizes from: 1.52m x 2.44m (5' x 8') to 3.05m x 4.87m (10 x 16)  
Eaves ht. 76" / 1937mm (back pent)  
Ridge ht. 85" / 2153mm (front pent)  
Double Doors 1790mm x 1103mm  
Front windows 1010mm x 475mm  
Side windows 1040mm x 717mm

Framing 38mm x 50mm  
Cladding 16mm x 125mm

### OPTIONS AVAILABLE

22mm Premier cladding  
19mm Log lap cladding  
22mm Floor boards  
50mm x 50mm framing  
2'6" veranda with fully tiled canopy in a choice of red, slate, green or black tiles  
Toughened Glass  
Choice of Georgian, diamond lead, or square lead glazing

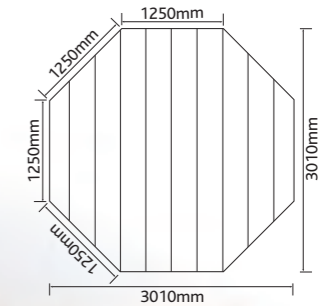
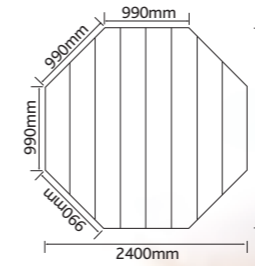

## Dual Pent Summerhouse

### STANDARD FEATURES

Half glazed arch top double doors with antique hinges, ornate handle and lever lock

2 Arch top fixed front windows

2 Arch top opening side windows

Integrated 4' storage room with side access by security door

Galvanised bolted hinges & padbolt protector to side access door

Profiled fascias

### SPECIFICATION

Sizes from: 1.83m x 2.44m (6' x 8') to 4.87m x 4.87m (16 x 16)

Eaves ht. 76" / 1937mm

Ridge ht. 85" / 2153mm

Security door 1867mm x 908mm fully framed and braced in 50mm x 50mm framing

Double Doors 1780mm x 1512mm (10' & above)

1780mm x 1103mm (8')

Front windows 445mm x 1010mm

Side windows 1040mm x 717mm

Framing 38mm x 50mm

Cladding 16mm x 125mm

### OPTIONS AVAILABLE

22mm Premier cladding

19mm Log lap cladding

22mm Floor boards

2'6" veranda with fully tiled canopy in a choice of red, slate, green or black tiles

Toughened Glass

Choice of Georgian, diamond lead, or square lead glazing

## Octagonal 8 and 10

### RED TILE



### STANDARD FEATURES

Half glazed joinery single door with antique hinges, ornate handle and lever lock

2 fully glazed top hung windows

2 fully glazed fixed windows

All side panels of the same size are fully interchangeable upon installation

Choice of tiled roof in red, slate, green or black

Door drip

Choice of georgian, diamond lead, or square lead glazing

### SPECIFICATION

Size: 8' x 8' / 2440mm x 2440mm

Eaves ht. 80" / 2035mm

Ridge ht. 99" / 2535mm

Door 1790mm x 762mm

Windows 1040mm x 717mm

Framing 38mm x 50mm

Cladding 16mm x 125mm

### OCTAGONAL 10 SPECIFICATION

size: 10' x 10' / 3050mm x 3050mm

Eaves ht. 80" / 2035mm

Ridge ht. 99" / 2535mm

Double doors 1790mm x 1103mm

### OPTIONS AVAILABLE

22mm premier cladding

19mm Log Lap cladding

22mm floorboards

Toughened glass

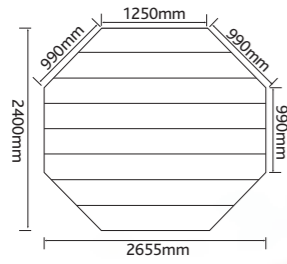

## Stretched Octagonal 8

### STANDARD FEATURES

Half glazed double doors with antique hinges, ornate handle and lever lock  
2 fully glazed top hung windows  
2 fully glazed fixed windows  
Choice of tiled roof in red, slate, green or black  
Door drip  
Choice of Georgian, diamond lead, or square lead glazing

### SPECIFICATION

size: 8' x 8'9" / 2440mm x 2667mm  
Eaves ht. 80" / 2035mm  
Ridge ht. 99" / 2535mm  
Door 1790mm x 1103mm  
Windows 1040mm x 717mm  
Framing 38mm x 50mm  
Cladding 16mm x 125mm

### OPTIONS AVAILABLE

22mm premier cladding  
19mm Log Lap cladding  
22mm floorboards  
Toughened glass



## The Sandringham

### STANDARD FEATURES

Georgian double doors to accommodate double glazing, antique hinges, ornate handle and lever lock  
2 Side 12 pane Georgian top hung opening windows to accommodate double glazing  
2 Front 12 pane Georgian fixed windows to accommodate double glazing  
The hipped roof comes with a choice of coloured felt tiles (not fitted)  
Heavy duty 3" x 2" framing throughout  
Toughened glass

### SPECIFICATION

Size 3.05m x 3.05 (10' x 10')  
Eaves height 2160mm / 85"  
Ridge height 3416mm / 136"  
Double doors 1790mm x 1103mm  
Windows 1360mm 718mm  
Framing 75mm x 50mm  
Cladding 16m x 125mm

### OPTIONS AVAILABLE

22mm Premier cladding  
19mm Log lap cladding  
22mm Heavy duty floor  
Coloured felt tiles with choice of Red, Green, Slate and Black  
Double glazed units  
Door and window options, plain, leaded and folding



## Toddlers Retreat

### STANDARD FEATURES

Two side windows with acrylic  
Door window Square acrylic  
Profiled fascias  
Antique door handle and hinges with adjustable door catch

### SPECIFICATION

Size: 4' X 4' (1.2m x 1.2m)  
Eaves ht. 42<sup>1</sup>/<sub>4</sub>" (1074mm)  
Ridge ht. 54<sup>1</sup>/<sub>2</sub>" (1384mm)  
Door 1074mm x 596mm  
Side windows 457mm x 457mm  
Door window 305mm x 305mm  
Framing 38mm x 50mm  
Cladding 16mm x 125mm

### OPTIONS AVAILABLE

22mm Premier cladding  
19mm Log lap  
Window Box  
2' veranda



## My Little Den

### STANDARD FEATURES

Door with diamond window, antique hinges and handle with adjustable door catch  
2 acrylic Georgian windows  
Roof overhang 1' / 305mm  
Profiled fascias

### SPECIFICATION

Sizes from: 1.22m x 1.83m (4' x 6') to 2.44m x 1.83m (8' x 6')  
Eaves ht. 51" / 1318mm  
Ridge ht. 73" / 1850mm  
Door 1282mm x 596mm  
Windows 457mm x 457mm

Framing 38mm x 50mm  
Cladding 16mm x 125mm

### OPTIONS AVAILABLE

22mm premier cladding  
19mm Log Lap cladding  
22mm floorboards  
Window box  
2' veranda (with or without) please specify  
Additional fixed side window  
Felt options



## Ladybird Cottage

### STANDARD FEATURES

Georgian joinery door with antique hinges and handle, with adjustable door catch

4 acrylic Georgian windows  
Roof overhang 1' / 305mm  
Profiled fascia boards

### SPECIFICATION

Sizes from: 1.52m x 2.13m (5' x 7') to 2.74m x 2.13m (7' x 7')  
Eaves ht. 49" / 1255mm  
Ridge ht. 70" / 1790mm  
Door 1180mm x 535mm  
Windows 457mm x 457mm

Framing 38mm x 50mm  
Cladding 16mm x 125mm

### OPTIONS AVAILABLE

22mm premier cladding  
19mm Log Lap cladding  
22mm floorboards  
2' verandah (with or without) please specify  
Felt options



## Snowdrop Cottage

### STANDARD FEATURES

Antique hinges and handle with adjustable door catch

4 acrylic Georgian windows

Georgian joinery door with antique hinges and handle with adjustable door catch

Chimney pot

Hip roof

Profiled fascia boards

### SPECIFICATION

Sizes: 1.83m x 1.22m (6' x 4') and 2.13m x 1.52m (7' x 5')  
Eaves ht. 51" / 1318mm

Ridge ht. 4' - 63" / 1615mm  
5' - 70" / 1790mm  
Door 1180mm x 535mm  
Windows 457mm x 457mm  
Framing 38mm x 50mm  
Cladding 16mm x 125mm

### OPTIONS AVAILABLE

22mm premier cladding  
19mm Log Lap cladding  
22mm floorboards  
Felt options



## Escape

### STANDARD FEATURES

Full size door with 10" diamond window, antique hinges and handle  
Internal bunk bed with safety rail, ladder and hand rail  
1 Acrylic Georgian window  
1 Window box  
Profiled fascias

### SPECIFICATION

Size 2.44m x 1.83m (8' x 6')  
Eaves 1964mm / 77"  
Ridge 2436 / 96"  
Door 1765mm x 762mm  
Window 457mm x 457mm  
Framing 38mm x 50mm  
Cladding 16mm x 125mm

### OPTIONS AVAILABLE

22mm Premier cladding  
19mm Log lap cladding  
22mm Floor boards  
Additional side windows  
Mirror image available  
Felt options



## Wilton Lodge

### STANDARD FEATURES

Door with diamond window, antique hinges and handle, with adjustable catch  
3 acrylic Georgian windows with large window box  
Roof overhang 1' / 305mm  
Internal bunk bed with safety rail  
Ladder with hand rail  
Profiled fascias

### SPECIFICATION

Sizes from: 1.52m x 2.13m (5' x 7') to 2.74m x 2.13m (9' x 7')  
Eaves ht. 56" / 1435mm to 70" / 1785mm

Ridge ht. 93" / 2350mm  
Door 1410mm x 596mm  
Windows 457mm x 457mm  
Framing 38mm x 50mm  
Cladding 16mm x 125mm

### OPTIONS AVAILABLE

22mm premier cladding  
19mm Log Lap cladding  
22mm floorboards  
Side fixed windows  
2' veranda (with or without) please specify  
Mirror image available  
Felt options







## Candy Cabin

### STANDARD FEATURES

Stable door with diamond in the top  
 Antique hinges and handle with adjustable closing catch  
 2 acrylic Georgian windows  
 1 window box  
 Internal bunk bed with safety rail, ladder with hand rail  
 Profiled fascias  
 Roof overhang 1' / 305mm

### SPECIFICATION

sizes: 1.83m x 2.44m (6' x 8') and 2.44m x 2.44m (8' x 8')  
 Eaves ht. 56" / 1435mm to 70" / 1785mm  
 Ridge ht. 93" / 2360mm

### Stable door:

Top 678mm x 596mm  
 Bottom 730mm x 596mm  
 Windows 457mm x 457mm  
 Framing 38mm x 50mm  
 Cladding 16mm x 125mm

### OPTIONS AVAILABLE

22mm premier cladding  
 19mm Log Lap cladding  
 22mm floorboards  
 Side fixed window  
 Window box  
 Mirror image available  
 2' veranda (with or without) please specify  
 Felt options



## The Hideaway

### STANDARD FEATURES

Single and double garage doors with diamond windows, complete with antique hinges and handles  
 2 acrylic Georgian windows  
 2 window boxes  
 Internal bunk bed with safety rail, ladder with hand rail  
 Profiled fascias  
 Roof overhang 1' / 305mm

### SPECIFICATION

sizes: 1.52m x 3.05m (5' x 10') and 1.83m x 3.05m (6' x 10')  
 Eaves ht. 56" / 1435mm to 70" / 1785mm  
 Ridge ht. 96" / 2430mm

Single door 1410mm x 596mm  
 Double door 1042mm x 1158mm  
 Windows 457mm x 457mm  
 Framing 38mm x 50mm  
 Cladding 16mm x 125mm

### OPTIONS AVAILABLE

22mm premier cladding  
 19mm Log Lap cladding  
 22mm floorboards  
 Additional side windows  
 Mirror image available  
 Felt options





## Charleys Castle

### STANDARD FEATURES

Door with antique hinges, handle and adjustable door catch  
 Diamond window in door  
 3 front acrylic Georgian windows  
 1 side acrylic Georgian window  
 Profiled fascias and veranda boards  
 2'6" veranda with front returns  
 Twin level upper bunk with ladder and handrail

### SPECIFICATION

Sizes: 2.59m x 3.05m (8'6" x 10') and 3.2m x 3.05m (10'6" x 10') including 2'6" verandah

Eaves ht. 66" / 1680mm  
 Ridge ht. 110" / 2810mm  
 Return veranda's 1070mm  
 Door 1410mm x 596mm  
 Windows 457mm x 457mm  
 Framing 38mm x 50mm  
 Cladding 16mm x 125mm

### OPTIONS AVAILABLE

22mm premier cladding  
 19mm Log Lap cladding  
 22mm floorboards  
 Side fixed window  
 Felt options



## Kids Club House

### STANDARD FEATURES

Door with antique hinges and handle with adjustable door catch  
 Diamond window in door  
 4 acrylic Georgian windows  
 Profiled fascias and veranda boards  
 3' veranda with side returns  
 Functional dormer window  
 Interior with raised bunk and guard rails  
 Ladder with hand rail

### SPECIFICATION

Sizes:  
 2.13m x 3.05m (7' x 10')  
 2.44m x 3.05m (8' x 10')  
 3.05m x 3.05m (10' x 10')

Eaves ht. 66" / 1680mm  
 Ridge ht. 110" / 2810mm  
 Door 1410mm x 596mm  
 Windows 457mm x 457mm  
 Framing 38mm x 50mm  
 Cladding 16mm x 125mm

### OPTIONS AVAILABLE

22mm premier cladding  
 19mm Log Lap cladding  
 22mm floorboards  
 Side fixed windows  
 Felt options

